

POWELL-NORTON HALL



Information available at WWW.EIU.EDU/HOUSING

Double Room: (Closet)

Entire lower level and 107, 109, 111, and 113

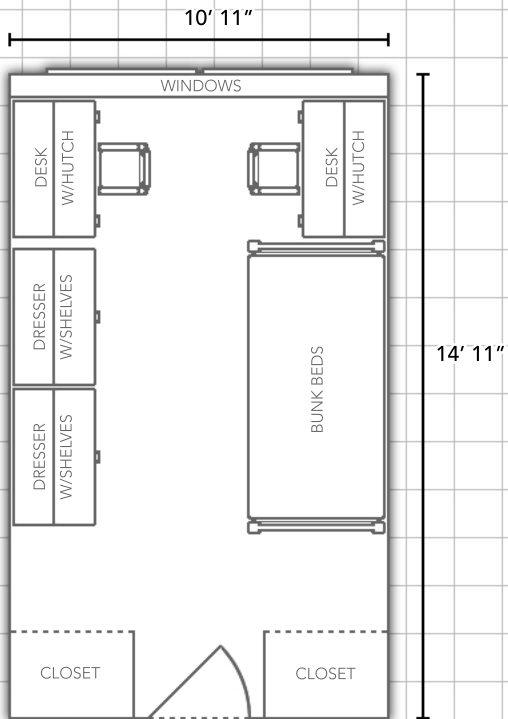

Double Room: (Wardrobe)

First floor (except for 107, 109, 111, and 113), Second and Third floor

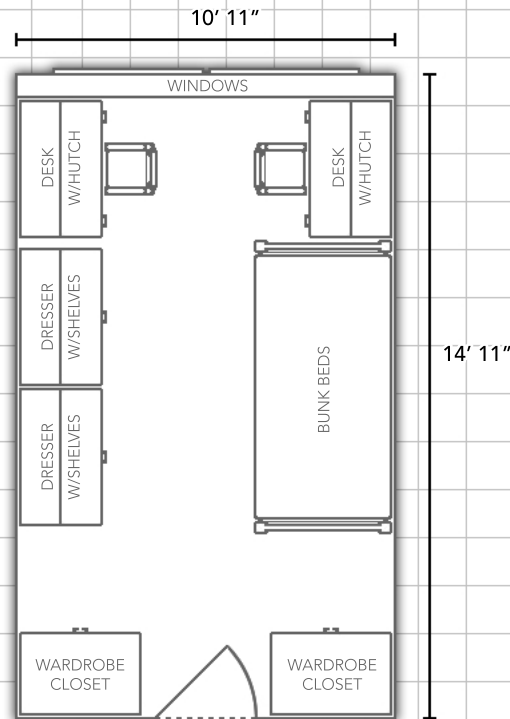

**MORE
LAYOUTS
ON BACK!** →

Department:

**Housing and
Dining Services**



EASTERN ILLINOIS UNIVERSITY™

Bedding:

Bedding in all rooms measure
80" X 39" (x-long twin)

Furnishings:

Rooms are carpeted and feature
stackable, loftable and
bunkable furniture

Miscellaneous:

Layouts are not to scale

Triple Room: (Wardrobe)

(Rooms 114, 224, 324)

